

GB Optional features **DE** Optionale Funktionen **FR** Options disponibles **NL** Opties
F Valinnaiset ominaisuudet **DK** Valgfrie funktioner **IT** Funzionalità opzionali **ES** Opciones disponi-
 bles **PT** Funções opcionais **GR** Προαιρετικές λειτουργίες **SE** Möjliga funktioner

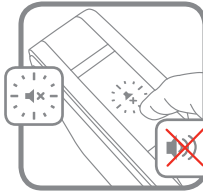

	Hello	Ding Dong	Westminster	Marimba	Piano	Bell	Telephone	Soft Alert
	•	•					•	•
	•	•	•	•			•	•
	•	•	•	•	•	•	•	•

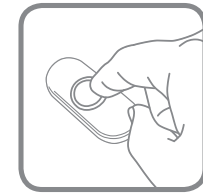
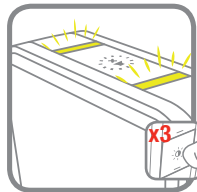
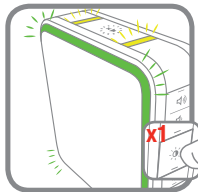
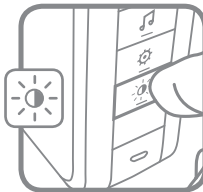

GB Linking **DE** Einlernen **FR** Programmation **NL** Programmeren
DK Verknøpning **F** Linkitämäminen **IT** Forbinde
PT Coligamento **ES** Enlace
GR Προγραμματισμός **SE** Länkning

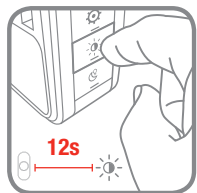
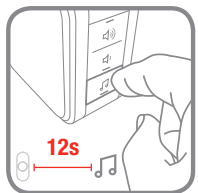
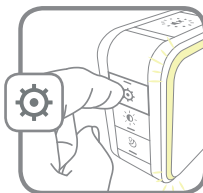

GB Trouble shooting **DE** Fehlerbehebung **FR** Dépannage **NL** Probleemoplossing
F Vianmääritys **DK** Problemløsning **IT** Risoluzione dei problemi **ES** Solución de
 problemas **PT** Resolução de problemas **GR** Αντιμετώπιση προβλημάτων **SE** Felsökning

livewell.honeywell.com



32304380-001 Rev.B



DE Contents 05 Inhalt 06 Contenu 06 Inhoud
 F Sisältö 06 Innhöld 07 Contenido
 ES Contenido 07 Conteúdo 08 Περιεχόμενα
 SE Innehåll



x1

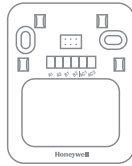

x1



x2



x2

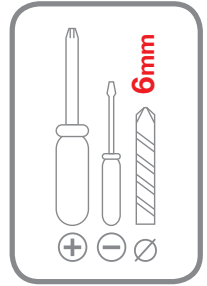

6mm

DE Getting started 05 Erste Schritte 06 Démarrage 06 Aan de slag
 F Aloituspäät 06 Kom i gång 07 Operazioni preliminari 08 Para empezar
 ES Para comenzar 08 Πρώτα βήματα 09 Kom igång

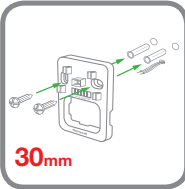
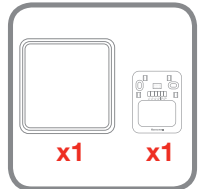
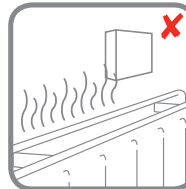
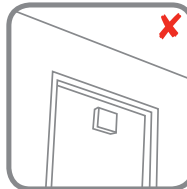
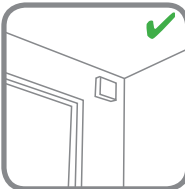

30mm

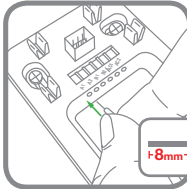

8mm

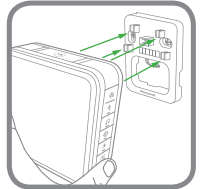
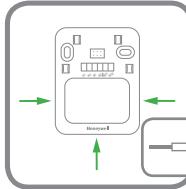

☞ Wired push with batteries ☞ Verdrahteter Drucktaster mit Batterien ☞ Bouton pousseur avec piles ☞ Bekabälde drukknoop met batterijen
☞ Johdotettu painike paristoilla ☞ Kabel tryk med batterier ☞ Pulsante cablato con batterie ☞ Pulsator cableado con baterías ☞ Boão com fios com pilhas
☞ Καλωδιωμένο ωστήριο με μπαταρίες ☞ Tråd bunden trykknapp med batterier

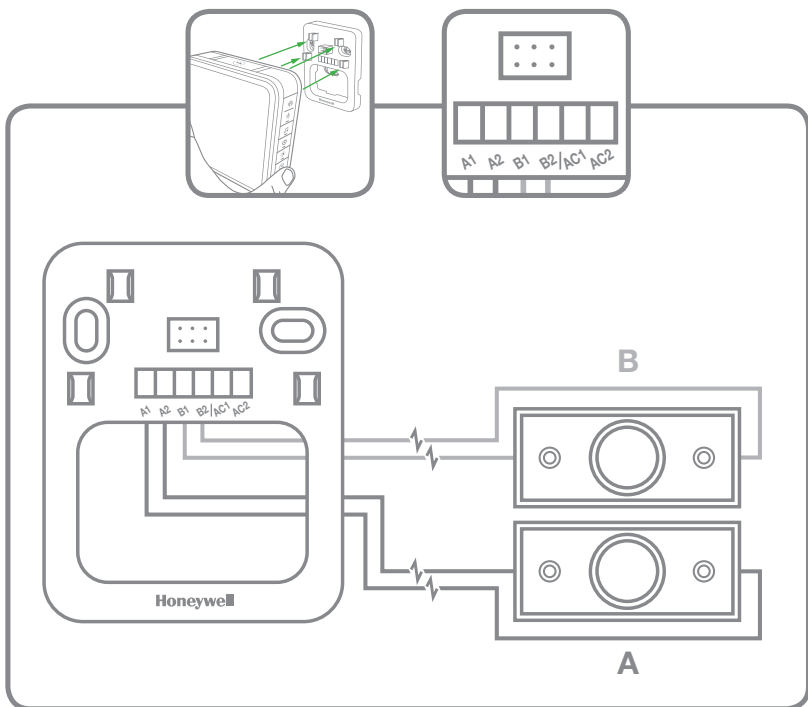

03 Wired illuminated push with transformer 03 Verdrahteter Druckknaster mit Beleuchtung und Transformator 03 Bouton poussoir éclairé avec transformateur
 04 Verlichte bekabelde drukknop met transformator 04 Johdotettu valaistu painike muuntajalla 04 Kabelt belyst tryk med transformør
 05 Pulsante cablato illuminato con trasformatore 05 Pulsador iluminado cableado con transformador 05 Botão iluminado com fios con transformador
 06 Καλωδιωμένο φωτιστικό με μετασχηματιστή 06 Trådbunden opplyst tryckknapp med transformator

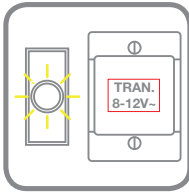

- GB Always ensure the main supply is disconnected before installation, follow Transformer Instructions.
- DE Immer daran denken, die Hauptversorgung vor der Installation abzuschalten. Dazu die Transformatoranweisungen befolgen.
- FR Assurez-vous toujours que l'alimentation principale est déconnectée avant l'installation. Respectez les consignes concernant le transformateur.

- NL Zorg er altijd voor dat de hoofdtoevoer afgesloten is voordat er met de installatie begonnen wordt, volg de instructies voor de transformator.
- FI Varmista aina, että päävirransyöttö on katkaistuna ennen asennusta, ja noudata muuntajan ohjeita.
- DK Sørg altid for, at strømmen er afbrudt før installation. Følg Transformer instruktionerne.
- IT Assicurarsi sempre che l'alimentazione principale sia scollegata prima di procedere con l'installazione. Seguire le istruzioni relative al trasformatore.
- ES Asegúrese siempre de que el suministro eléctrico está desconectado antes de la instalación, siga las instrucciones del transformador.
- PT Certifique-se sempre de que a fonte de alimentação principal é desligada antes da instalação e siga as instruções do transformador.
- GR Να βεβαιώνετε πάντοτε ότι η κύρια παροχή είναι αποσυνδεδεμένη πριν από την εγκατάσταση, τηρείτε τις Οδηγίες για τον Μετασχηματιστή
- SE Se alltid till att elnätet är bortkopplat innan installationen och följ transformatorns instruktioner.

